

Die Weiterentwicklung unserer höchst erfolgreichen Schnellsteckverbinder-Serie im Material Messing vernickelt.

Die Vorteile der weiterentwickelten Baureihe sind:

- wesentlich einfacheres Stecken und Lösen des Schlauches, vielfach wiederholbar
- verwendbar auch bei nichtkalibrierten Schläuchen
- geeignet für den Vakuumbetrieb

Arbeitsdruck: max. 16 bar
 Betriebstemperatur: -20 °C bis +80 °C
 Material: Messing vernickelt
 Lösering: Hostaform
 Spanning: Edelstahl
 O-Ring: NBR

⇒ Hinweis: Unsere Reduzierungen, Verschlussstecker und Verlängerungen sind nicht geeignet für die T-Schwenk-Steckverbinder Serie 758 und die Mehrfach-Steckverbindungen Serien 759, 760 und 761.

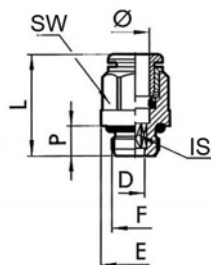

745.014-8

Gerade Steckverschraubungen, Außengewinde zylindrisch mit O-Ring und Außensechskant (M-Gewinde ohne Außensechskant)

| Artikel Nr. | Ident Nr. | Ø mm | F mm | SW mm | IS mm | P mm | L mm | D mm | E mm |
|-------------|-----------|------|-------|-------|-------|------|------|------|------|
| 745.003-3 | 108547 | 3 | M3 | Ø 5,8 | 1,5 | 3,0 | 12,6 | 1,5 | 5,8 |
| 745.005-3 | 108548 | 3 | M5 | Ø 5,8 | 2 | 3,5 | 13,0 | 2,0 | 5,8 |
| 745.005-4 | 108549 | 4 | M5 | Ø 9 | 2,5 | 4,0 | 20,3 | 2,6 | 9,0 |
| 745.005-5 | 108550 | 5 | M5 | Ø 12 | 2,5 | 4,0 | 22,5 | 2,6 | 12,0 |
| 745.005-6 | 108551 | 6 | M5 | Ø 11 | 2,5 | 4,0 | 21,9 | 2,6 | 11,0 |
| 745.007-4 | 108552 | 4 | M7 | Ø 9 | 3 | 4,0 | 18,9 | 3,1 | 9,8 |
| 745.007-6 | 108553 | 6 | M7 | Ø 11 | 4 | 5,0 | 23,0 | 4,1 | 11,0 |
| 745.018-4 | 108554 | 4 | G 1/8 | 10 | 3 | 6,0 | 18,0 | 3,1 | 14,0 |
| 745.018-5 | 108555 | 5 | G 1/8 | 13 | 3 | 6,0 | 22,0 | 3,1 | 15,0 |
| 745.018-6 | 108556 | 6 | G 1/8 | 12 | 4 | 6,0 | 21,6 | 4,1 | 14,0 |
| 745.018-8 | 108557 | 8 | G 1/8 | 13 | 5 | 6,0 | 25,4 | 5,2 | 14,0 |
| 745.014-4 | 108558 | 4 | G 1/4 | 10 | 3 | 8,0 | 19,8 | 3,1 | 18,0 |
| 745.014-5 | 108559 | 5 | G 1/4 | 12 | 3 | 8,0 | 24,0 | 3,1 | 18,0 |
| 745.014-6 | 108560 | 6 | G 1/4 | 12 | 4 | 8,0 | 20,3 | 4,1 | 18,0 |
| 745.014-8 | 108561 | 8 | G 1/4 | 14 | 6 | 8,0 | 24,4 | 6,2 | 18,0 |
| 745.014-10 | 108562 | 10 | G 1/4 | 16 | 7 | 8,0 | 29,2 | 7,2 | 18,0 |
| 745.014-12 | 108563 | 12 | G 1/4 | 19 | 7 | 8,0 | 30,5 | 7,2 | 21,0 |
| 745.038-8 | 108564 | 8 | G 3/8 | 14 | 6 | 9,0 | 22,8 | 6,2 | 22,0 |
| 745.038-10 | 108565 | 10 | G 3/8 | 16 | 8 | 9,0 | 26,5 | 8,2 | 22,0 |
| 745.038-12 | 108566 | 12 | G 3/8 | 19 | 10 | 9,0 | 28,1 | 10,2 | 22,0 |
| 745.038-14 | 108567 | 14 | G 3/8 | 22 | 10 | 9,0 | 33,8 | 10,2 | 24,6 |
| 745.012-10 | 108568 | 10 | G 1/2 | 16 | 8 | 11,0 | 29,8 | 8,2 | 26,0 |
| 745.012-12 | 108569 | 12 | G 1/2 | 19 | 10 | 11,0 | 29,3 | 10,2 | 26,0 |
| 745.012-14 | 108570 | 14 | G 1/2 | 22 | 12 | 11,0 | 31,5 | 12,2 | 26,0 |

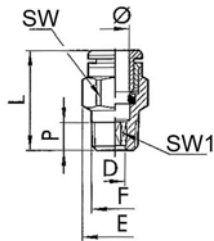

744.018-6

Gerade Steckverschraubungen, Außengewinde konisch mit Außensechskant

| Artikel Nr. | Ident Nr. | Ø mm | F mm | SW mm | SW1 mm | D mm | E mm | L mm | P mm |
|-------------|-----------|------|-------|-------|--------|------|------|------|------|
| 744.018-4 | 108584 | 4 | R 1/8 | 10 | 3 | 3,1 | 11,3 | 18,5 | 6,2 |
| 744.018-6 | 108585 | 6 | R 1/8 | 12 | 4 | 4,1 | 13,5 | 22,5 | 6,2 |
| 744.018-8 | 108586 | 8 | R 1/8 | 13 | 5 | 5,2 | 14,3 | 26,0 | 6,2 |
| 744.014-6 | 108587 | 6 | R 1/4 | 12 | 4 | 4,1 | 13,2 | 22,3 | 8,5 |
| 744.014-8 | 108588 | 8 | R 1/4 | 14 | 6 | 6,2 | 15,8 | 25,5 | 8,5 |
| 744.014-10 | 108589 | 10 | R 1/4 | 16 | 7 | 7,2 | 17,7 | 28,9 | 8,5 |
| 744.038-8 | 108590 | 8 | R 3/8 | 14 | 6 | 6,2 | 16,6 | 24,9 | 9,0 |
| 744.038-10 | 108591 | 10 | R 3/8 | 16 | 7 | 7,2 | 17,7 | 28,9 | 9,0 |
| 744.038-12 | 108592 | 12 | R 3/8 | 19 | 10 | 10,2 | 21,0 | 27,0 | 9,0 |
| 744.012-12 | 108593 | 12 | R 1/2 | 19 | 10 | 10,2 | 21,3 | 26,6 | 11,0 |

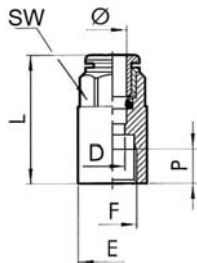

746.018-6

Gerade Steckverschraubungen, Innengewinde zylindrisch mit Außensechskant

| Artikel Nr. | Ident Nr. | Ø mm | F mm | SW mm | P mm | L mm | D mm | E mm |
|-------------|-----------|------|-------|-------|------|------|------|------|
| 746.005-3 | 108571 | 3 | M5 | 7 | 4,5 | 15,7 | 2,5 | 7,8 |
| 746.018-4 | 108572 | 4 | G 1/8 | 10 | 7,0 | 26,2 | 3,0 | 14,0 |
| 746.018-5 | 108573 | 5 | G 1/8 | 12 | 7,0 | 27,5 | 4,0 | 14,0 |
| 746.018-6 | 108574 | 6 | G 1/8 | 12 | 7,0 | 27,1 | 5,0 | 14,0 |
| 746.018-8 | 108575 | 8 | G 1/8 | 13 | 7,0 | 28,1 | 7,0 | 14,0 |
| 746.014-4 | 108576 | 4 | G 1/4 | 10 | 8,0 | 28,6 | 3,0 | 17,0 |
| 746.014-5 | 108577 | 5 | G 1/4 | 12 | 8,0 | 29,5 | 4,0 | 17,0 |
| 746.014-6 | 108578 | 6 | G 1/4 | 12 | 8,0 | 29,3 | 5,0 | 17,0 |
| 746.014-8 | 108579 | 8 | G 1/4 | 14 | 8,0 | 30,0 | 7,0 | 17,0 |
| 746.014-10 | 108580 | 10 | G 1/4 | 16 | 8,0 | 31,8 | 8,0 | 17,7 |
| 746.038-10 | 108581 | 10 | G 3/8 | 16 | 10,0 | 36,8 | 8,0 | 20,8 |
| 746.038-12 | 108582 | 12 | G 3/8 | 19 | 10,0 | 37,0 | 10,0 | 20,8 |
| 746.012-12 | 108583 | 12 | G 1/2 | 19 | 11,0 | 40,5 | 10,0 | 23,8 |

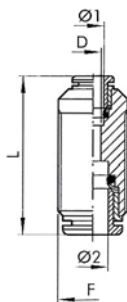

747.008

Gerade Steckverbindungen

| Artikel Nr. | Ident Nr. | Ø1 mm | Ø2 mm | F mm | L mm | D mm |
|-------------|-----------|-------|-------|---------|------|------|
| 747.003-3 | 108720 | 3 | 3 | M8x0,75 | 18,4 | 2,0 |
| 747.004 | 108721 | 4 | 4 | M11x1,0 | 30,6 | 2,5 |
| 747.0406 | 108728 | 4 | 6 | M13x1,0 | 32,7 | 2,5 |
| 747.005 | 108722 | 5 | 5 | M14x1,0 | 33,5 | 4,0 |
| 747.006 | 108723 | 6 | 6 | M13x1,0 | 33,0 | 4,5 |
| 747.0408 | 108729 | 4 | 8 | M15x1,0 | 34,4 | 2,5 |
| 747.0608 | 108730 | 6 | 8 | M15x1,0 | 35,0 | 4,5 |
| 747.008 | 108724 | 8 | 8 | M15x1,0 | 35,7 | 6,5 |
| 747.0610 | 108731 | 6 | 10 | M17x1,0 | 37,5 | 4,5 |
| 747.0612 | 108732 | 6 | 12 | M20x1,0 | 39,0 | 4,5 |
| 747.0810 | 108733 | 8 | 10 | M17x1,0 | 37,8 | 6,5 |
| 747.0812 | 108734 | 8 | 12 | M20x1,0 | 40,1 | 6,0 |
| 747.010 | 108725 | 10 | 10 | M17x1,0 | 39,2 | 8,0 |
| 747.012 | 108726 | 12 | 12 | M20x1,0 | 39,7 | 10,0 |
| 747.014 | 108727 | 14 | 14 | M24x1,0 | 45,9 | 12,0 |
| 747.1012 | 108735 | 10 | 12 | M20x1,0 | 40,8 | 8,0 |

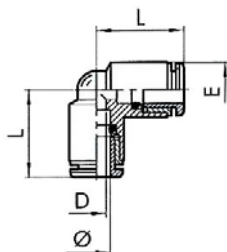

748.006

L-Steckverbindungen

| Artikel Nr. | Ident Nr. | Ø mm | L mm | D mm | E mm |
|-------------|-----------|------|------|------|------|
| 748.003 | 108752 | 3 | 10,4 | 2,0 | 6,3 |
| 748.004 | 108753 | 4 | 16,7 | 2,5 | 10,0 |
| 748.005 | 108754 | 5 | 19,2 | 3,0 | 13,5 |
| 748.006 | 108755 | 6 | 19,0 | 4,5 | 11,5 |
| 748.008 | 108756 | 8 | 21,3 | 6,5 | 13,5 |
| 748.010 | 108757 | 10 | 23,3 | 8,0 | 15,5 |
| 748.012 | 108758 | 12 | 26,0 | 10,0 | 20,5 |
| 748.014 | 108759 | 14 | 29,3 | 12,0 | 22,0 |

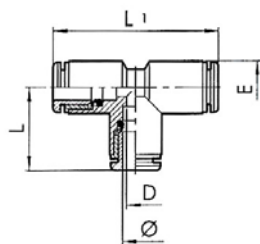

749.006

T-Steckverbindungen

| Artikel Nr. | Ident Nr. | Ø mm | L mm | L1 mm | D mm | E mm |
|-------------|-----------|------|------|-------|------|------|
| 749.003 | 108760 | 3 | 10,4 | 21,2 | 2,0 | 6,3 |
| 749.004 | 108761 | 4 | 16,7 | 33,4 | 2,5 | 10,0 |
| 749.005 | 108762 | 5 | 19,2 | 38,4 | 3,0 | 13,5 |
| 749.006 | 108763 | 6 | 19,0 | 38,0 | 4,5 | 11,5 |
| 749.008 | 108764 | 8 | 21,3 | 42,6 | 6,5 | 13,5 |
| 749.010 | 108765 | 10 | 23,3 | 46,6 | 8,0 | 15,5 |
| 749.012 | 108766 | 12 | 26,0 | 52,0 | 10,0 | 20,5 |
| 749.014 | 108767 | 14 | 29,3 | 58,6 | 12,0 | 22,0 |

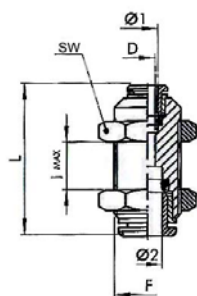

751.016-8

Gerade Schott-Steckverbindungen

| Artikel Nr. | Ident Nr. | Ø1 mm | Ø2 mm | F mm | SW mm | L mm | D mm | l max mm |
|--------------|-----------|-------|-------|---------|-------|------|------|----------|
| 751.008-3 | 108736 | 3 | 3 | M8x0,75 | 10 | 18,4 | 2,0 | 5,0 |
| 751.012-4 | 108737 | 4 | 4 | M11x1,0 | 13 | 30,6 | 2,5 | 11,0 |
| 751.013-46 | 108744 | 4 | 6 | M13x1,0 | 16 | 32,7 | 2,5 | 11,0 |
| 751.014-5 | 108738 | 5 | 5 | M14x1,0 | 17 | 33,5 | 4,0 | 8,0 |
| 751.014-6 | 108739 | 6 | 6 | M13x1,0 | 16 | 33,0 | 4,5 | 12,0 |
| 751.015-48 | 108745 | 4 | 8 | M15x1,0 | 17 | 34,4 | 2,5 | 12,0 |
| 751.015-68 | 108746 | 6 | 8 | M15x1,0 | 17 | 35,0 | 4,5 | 13,0 |
| 751.016-8 | 108740 | 8 | 8 | M15x1,0 | 17 | 35,7 | 6,5 | 13,5 |
| 751.017-610 | 108747 | 6 | 10 | M17x1,0 | 20 | 37,5 | 4,5 | 14,5 |
| 751.017-810 | 108748 | 8 | 10 | M17x1,0 | 20 | 37,8 | 6,5 | 15,0 |
| 751.020-10 | 108741 | 10 | 10 | M17x1,0 | 20 | 39,2 | 8,0 | 17,0 |
| 751.022-12 | 108742 | 12 | 12 | M20x1,0 | 24 | 40,7 | 10,0 | 20,3 |
| 751.020-612 | 108749 | 6 | 12 | M20x1,0 | 24 | 39,0 | 4,5 | 16,0 |
| 751.020-812 | 108750 | 8 | 12 | M20x1,0 | 24 | 40,1 | 6,0 | 17,5 |
| 751.020-1012 | 108751 | 10 | 12 | M20x1,0 | 24 | 40,8 | 8,0 | 19,0 |
| 751.024-14 | 108743 | 14 | 14 | M24x1,0 | 27 | 45,9 | 12,0 | 21,9 |

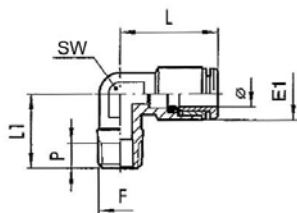

752.018-6

L-Steckverschraubungen, Außengewinde konisch

| Artikel Nr. | Ident Nr. | Ø mm | F mm | SW mm | E1 mm | L mm | L1 mm | P mm |
|-------------|-----------|------|-------|-------|-------|------|-------|------|
| 752.018-4 | 108624 | 4 | R 1/8 | 10 | 9,5 | 18,6 | 16,0 | 6,2 |
| 752.018-6 | 108625 | 6 | R 1/8 | 10 | 11,8 | 21,9 | 16,0 | 6,2 |
| 752.018-8 | 108626 | 8 | R 1/8 | 10 | 13,5 | 25,4 | 16,0 | 6,2 |
| 752.014-6 | 108627 | 6 | R 1/4 | 10 | 11,8 | 21,9 | 18,5 | 8,5 |
| 752.014-8 | 108628 | 8 | R 1/4 | 10 | 13,5 | 25,4 | 18,5 | 8,5 |
| 752.014-10 | 108629 | 10 | R 1/4 | 14 | 16,0 | 27,2 | 22,0 | 8,5 |

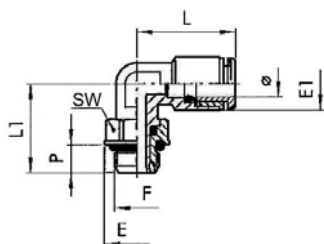

754.018-6

L-Steckverschraubungen, drehbar, Außengewinde zylindrisch mit O-ring

| Artikel Nr. | Ident Nr. | Ø mm | F mm | SW mm | E mm | E1 mm | L mm | L1 mm | P mm |
|-------------|-----------|------|-------|-------|------|-------|------|-------|------|
| 754.005-4 | 108594 | 4 | M5 | 9 | 9,9 | 9,5 | 18,6 | 15,3 | 4,0 |
| 754.005-5 | 108595 | 5 | M5 | 9 | 9,9 | 11,5 | 22,8 | 15,3 | 4,0 |
| 754.005-6 | 108596 | 6 | M5 | 9 | 9,9 | 11,8 | 21,9 | 15,3 | 4,0 |
| 754.018-4 | 108597 | 4 | G 1/8 | 12 | 14,0 | 9,5 | 18,6 | 19,1 | 6,0 |
| 754.018-5 | 108598 | 5 | G 1/8 | 12 | 15,0 | 11,5 | 22,8 | 19,1 | 6,0 |
| 754.018-6 | 108599 | 6 | G 1/8 | 12 | 14,0 | 11,8 | 21,9 | 19,1 | 6,0 |
| 754.018-8 | 108600 | 8 | G 1/8 | 12 | 14,0 | 13,5 | 25,4 | 19,1 | 6,0 |
| 754.014-4 | 108601 | 4 | G 1/4 | 14 | 18,0 | 9,5 | 18,6 | 21,1 | 8,0 |
| 754.014-5 | 108602 | 5 | G 1/4 | 14 | 18,0 | 13,5 | 22,8 | 21,8 | 8,0 |
| 754.014-6 | 108603 | 6 | G 1/4 | 14 | 18,0 | 11,8 | 21,9 | 21,1 | 8,0 |
| 754.014-8 | 108604 | 8 | G 1/4 | 14 | 18,0 | 13,5 | 25,4 | 21,1 | 8,0 |
| 754.014-10 | 108605 | 10 | G 1/4 | 14 | 18,0 | 16,0 | 27,2 | 24,8 | 8,0 |
| 754.014-12 | 108606 | 12 | G 1/4 | 14 | 18,0 | 20,0 | 30,0 | 25,6 | 8,0 |
| 754.038-8 | 108607 | 8 | G 3/8 | 17 | 22,0 | 13,8 | 23,6 | 27,1 | 9,0 |
| 754.038-10 | 108608 | 10 | G 3/8 | 17 | 22,0 | 16,0 | 27,2 | 27,1 | 9,0 |
| 754.038-12 | 108609 | 12 | G 3/8 | 17 | 22,0 | 20,0 | 30,0 | 27,1 | 9,0 |
| 754.012-10 | 108610 | 10 | G 1/2 | 22 | 26,0 | 16,0 | 27,2 | 30,7 | 11,0 |
| 754.012-12 | 108611 | 12 | G 1/2 | 22 | 26,0 | 20,0 | 30,0 | 30,7 | 11,0 |
| 754.012-14 | 108612 | 14 | G 1/2 | 22 | 26,0 | 21,3 | 33,0 | 32,3 | 11,0 |

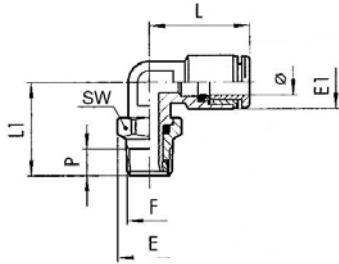

7754.018-6

L-Steckverschraubungen, drehbar, Außengewinde konisch

| Artikel Nr. | Ident Nr. | Ø mm | F mm | SW mm | E mm | E1 mm | L mm | L1 mm | P mm |
|-------------|-----------|------|-------|-------|------|-------|------|-------|------|
| 7754.018-4 | 108613 | 4 | R 1/8 | 12 | 13,3 | 9,5 | 18,6 | 19,8 | 6,2 |
| 7754.018-6 | 108614 | 6 | R 1/8 | 12 | 13,3 | 11,8 | 21,9 | 19,8 | 6,2 |
| 7754.018-8 | 108615 | 8 | R 1/8 | 12 | 13,3 | 13,5 | 25,4 | 19,8 | 6,2 |
| 7754.014-4 | 108616 | 4 | R 1/4 | 14 | 15,4 | 9,5 | 18,6 | 22,6 | 8,5 |
| 7754.014-6 | 108617 | 6 | R 1/4 | 14 | 15,4 | 11,8 | 21,9 | 22,6 | 8,5 |
| 7754.014-8 | 108618 | 8 | R 1/4 | 14 | 15,4 | 13,5 | 25,4 | 23,6 | 8,5 |
| 7754.014-10 | 108619 | 10 | R 1/4 | 14 | 15,4 | 16,0 | 27,2 | 26,3 | 8,5 |
| 7754.038-8 | 108620 | 8 | R 3/8 | 17 | 19,2 | 13,8 | 23,6 | 27,1 | 9,0 |
| 7754.038-10 | 108621 | 10 | R 3/8 | 17 | 19,2 | 16,0 | 27,2 | 27,1 | 9,0 |
| 7754.038-12 | 108622 | 12 | R 3/8 | 17 | 19,2 | 20,0 | 30,0 | 27,1 | 9,0 |
| 7754.012-12 | 108623 | 12 | R 1/2 | 22 | 24,6 | 20,0 | 30,0 | 31,9 | 11,0 |

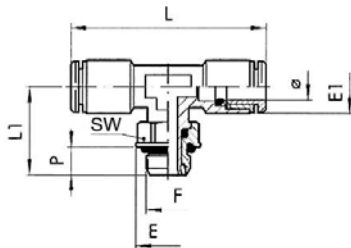

755.018-6

T-Steckverschraubungen, drehbar, Außengewinde zylindrisch mit O-Ring

| Artikel Nr. | Ident Nr. | Ø mm | F mm | SW mm | E mm | E1 mm | L mm | L1 mm | P mm |
|-------------|-----------|------|-------|-------|------|-------|------|-------|------|
| 755.005-4 | 108649 | 4 | M5 | 9 | 9,9 | 9,5 | 37,2 | 15,3 | 4,0 |
| 755.005-6 | 108650 | 6 | M5 | 9 | 9,9 | 11,8 | 43,8 | 15,3 | 4,0 |
| 755.018-4 | 108651 | 4 | G 1/8 | 12 | 14,0 | 9,5 | 37,2 | 19,1 | 6,0 |
| 755.018-5 | 108652 | 5 | G 1/8 | 12 | 15,2 | 11,5 | 44,6 | 19,1 | 6,0 |
| 755.018-6 | 108653 | 6 | G 1/8 | 12 | 14,0 | 11,8 | 43,8 | 19,1 | 6,0 |
| 755.018-8 | 108654 | 8 | G 1/8 | 12 | 15,2 | 13,5 | 50,8 | 19,1 | 6,0 |
| 755.014-4 | 108655 | 4 | G 1/4 | 14 | 18,0 | 9,5 | 37,2 | 21,1 | 8,0 |
| 755.014-6 | 108656 | 6 | G 1/4 | 14 | 18,0 | 11,8 | 43,8 | 21,1 | 8,0 |
| 755.014-8 | 108657 | 8 | G 1/4 | 14 | 18,0 | 13,5 | 50,8 | 21,1 | 8,0 |
| 755.014-10 | 108658 | 10 | G 1/4 | 14 | 18,0 | 16,0 | 54,4 | 21,8 | 8,0 |
| 755.038-8 | 108659 | 8 | G 3/8 | 17 | 22,0 | 13,8 | 47,2 | 27,1 | 9,0 |
| 755.038-10 | 108660 | 10 | G 3/8 | 17 | 22,0 | 16,0 | 54,4 | 27,1 | 9,0 |
| 755.038-12 | 108661 | 12 | G 3/8 | 17 | 22,0 | 20,0 | 59,0 | 27,1 | 9,0 |
| 755.012-12 | 108662 | 12 | G 1/2 | 22 | 26,0 | 20,0 | 59,0 | 30,7 | 11,0 |
| 755.012-14 | 108663 | 14 | G 1/2 | 22 | 26,0 | 21,3 | 66,0 | 32,3 | 11,0 |

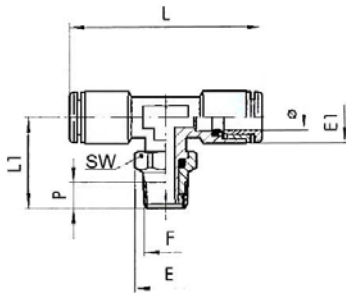

7755.018-6

T-Steckverschraubung, drehbar, Außengewinde konisch

| Artikel Nr. | Ident Nr. | Ø mm | F mm | SW mm | E mm | E1 mm | L mm | L1 mm | P mm |
|-------------|-----------|------|-------|-------|------|-------|------|-------|------|
| 7755.018-4 | 108664 | 4 | R 1/8 | 12 | 13,3 | 9,5 | 37,2 | 19,8 | 6,2 |
| 7755.018-6 | 108665 | 6 | R 1/8 | 12 | 13,3 | 11,8 | 43,8 | 19,8 | 6,2 |
| 7755.018-8 | 108666 | 8 | R 1/8 | 12 | 13,3 | 13,5 | 50,8 | 19,8 | 6,2 |
| 7755.014-4 | 108667 | 4 | R 1/4 | 14 | 15,4 | 9,5 | 37,2 | 22,6 | 8,5 |
| 7755.014-6 | 108668 | 6 | R 1/4 | 14 | 15,4 | 11,8 | 43,8 | 22,6 | 8,5 |
| 7755.014-8 | 108669 | 8 | R 1/4 | 14 | 15,4 | 13,5 | 50,8 | 23,6 | 8,5 |
| 7755.014-10 | 108670 | 10 | R 1/4 | 14 | 15,4 | 16,0 | 54,4 | 26,3 | 8,5 |
| 7755.038-8 | 108671 | 8 | R 3/8 | 17 | 19,2 | 13,8 | 47,2 | 27,1 | 9,0 |
| 7755.038-10 | 108672 | 10 | R 3/8 | 17 | 19,2 | 16,0 | 54,4 | 27,1 | 9,0 |

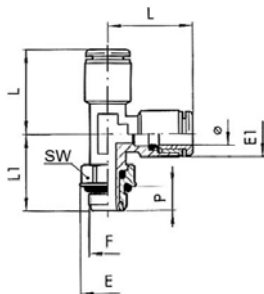

738.038-12

T-Steckverschraubungen, Steckanschlüsse in L-Form, drehbar, Außengewinde zylindrisch mit O-Ring

| Artikel Nr. | Ident Nr. | Ø mm | F mm | SW mm | E mm | E1 mm | L mm | L1 mm | P mm |
|-------------|-----------|------|-------|-------|------|-------|------|-------|------|
| 738.018-4 | 108690 | 4 | G 1/8 | 12 | 14,0 | 9,5 | 18,6 | 19,1 | 6,0 |
| 738.018-6 | 108691 | 6 | G 1/8 | 12 | 14,0 | 11,5 | 21,9 | 19,1 | 6,0 |
| 738.018-8 | 108692 | 8 | G 1/8 | 12 | 14,0 | 13,5 | 25,4 | 19,1 | 6,0 |
| 738.014-6 | 108693 | 6 | G 1/4 | 14 | 18,0 | 11,5 | 21,9 | 21,1 | 8,0 |
| 738.014-8 | 108694 | 8 | G 1/4 | 14 | 18,0 | 13,5 | 25,4 | 22,1 | 8,0 |
| 738.014-10 | 108695 | 10 | G 1/4 | 14 | 18,0 | 16,0 | 27,2 | 21,8 | 8,0 |
| 738.038-10 | 108696 | 10 | G 3/8 | 17 | 22,0 | 16,0 | 27,2 | 27,1 | 9,0 |
| 738.038-12 | 108697 | 12 | G 3/8 | 17 | 22,0 | 20,0 | 30,0 | 27,1 | 9,0 |
| 738.012-12 | 108698 | 12 | G 1/2 | 22 | 26,0 | 20,0 | 30,0 | 30,7 | 11,0 |

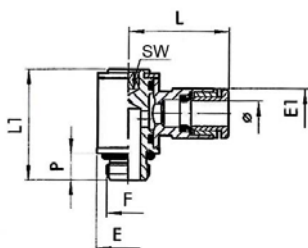

756.018-6

L-Steckverschraubungen mit Innensechskant, drehbar, Außengewinde zylindrisch mit O-Ring

| Artikel Nr. | Ident Nr. | Ø mm | F mm | SW mm | P mm | L mm | L1 mm | E mm | E1 mm |
|-------------|-----------|------|-------|-------|------|------|-------|------|-------|
| 756.003-3 | 108630 | 3 | M3 | 2 | 3,0 | 12,2 | 13,2 | 5,8 | 5,8 |
| 756.005-3 | 108631 | 3 | M5 | 2 | 3,5 | 12,7 | 13,7 | 5,8 | 5,8 |
| 756.005-4 | 108632 | 4 | M5 | 2 | 4,0 | 20,2 | 18,4 | 9,5 | 9,5 |
| 756.005-5 | 108633 | 5 | M5 | 2 | 4,0 | 24,0 | 19,0 | 9,9 | 12,0 |
| 756.005-6 | 108634 | 6 | M5 | 2 | 4,0 | 23,5 | 18,4 | 9,5 | 11,3 |
| 756.007-4 | 108635 | 4 | M7 | 3 | 5,0 | 20,2 | 18,5 | 9,8 | 9,5 |
| 756.007-6 | 108636 | 6 | M7 | 3 | 5,0 | 23,5 | 18,5 | 9,8 | 11,3 |
| 756.018-4 | 108637 | 4 | G 1/8 | 3 | 6,0 | 21,3 | 24,9 | 14,0 | 9,5 |
| 756.018-5 | 108638 | 5 | G 1/8 | 3 | 6,0 | 24,8 | 26,2 | 14,0 | 12,0 |
| 756.018-6 | 108639 | 6 | G 1/8 | 3 | 6,0 | 23,0 | 24,9 | 14,0 | 11,5 |
| 756.018-8 | 108640 | 8 | G 1/8 | 3 | 6,0 | 24,8 | 24,9 | 14,0 | 13,8 |
| 756.014-6 | 108641 | 6 | G 1/4 | 4 | 8,0 | 24,5 | 29,4 | 18,0 | 11,5 |
| 756.014-8 | 108642 | 8 | G 1/4 | 4 | 8,0 | 26,5 | 29,4 | 18,0 | 13,8 |
| 756.014-10 | 108643 | 10 | G 1/4 | 4 | 8,0 | 31,4 | 29,4 | 18,0 | 16,5 |
| 756.014-12 | 108644 | 12 | G 1/4 | 4 | 8,0 | 33,0 | 29,4 | 18,0 | 19,5 |
| 756.038-8 | 108645 | 8 | G 3/8 | 5 | 9,0 | 28,5 | 35,6 | 22,0 | 13,8 |
| 756.038-10 | 108646 | 10 | G 3/8 | 5 | 9,0 | 32,8 | 35,6 | 22,0 | 15,5 |
| 756.038-12 | 108647 | 12 | G 3/8 | 5 | 9,0 | 35,3 | 35,6 | 22,0 | 19,5 |
| 756.012-12 | 108648 | 12 | G 1/2 | 8 | 11,0 | 37,0 | 40,8 | 26,0 | 19,5 |

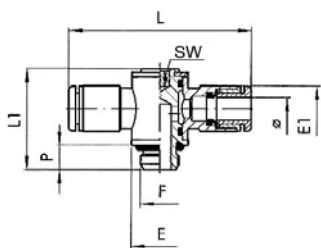

758.018-4 M

T-Steckverschraubungen mit Innensechskant, drehbar, Außengewinde zylindrisch mit O-Ring

| Artikel Nr. | Ident Nr. | Ø mm | F mm | SW mm | P mm | L mm | L1 mm | E mm | E1 mm |
|--------------|-----------|------|-------|-------|------|------|-------|------|-------|
| 758.005-4 M | 108673 | 4 | M5 | 2 | 4,0 | 40,4 | 18,4 | 9,5 | 9,5 |
| 758.005-5 M | 108674 | 5 | M5 | 2 | 4,0 | 47,6 | 18,8 | 9,9 | 12,0 |
| 758.005-6 M | 108675 | 6 | M5 | 2 | 4,0 | 47,0 | 18,4 | 9,5 | 11,3 |
| 758.007-4 M | 108676 | 4 | M7 | 3 | 5,0 | 40,4 | 18,5 | 9,8 | 9,5 |
| 758.007-6 M | 108677 | 6 | M7 | 3 | 5,0 | 47,0 | 18,5 | 9,8 | 11,3 |
| 758.018-4 M | 108678 | 4 | G 1/8 | 3 | 6,0 | 42,6 | 24,9 | 14,0 | 9,5 |
| 758.018-5 M | 108679 | 5 | G 1/8 | 3 | 6,0 | 49,5 | 27,0 | 14,0 | 13,5 |
| 758.018-6 M | 108680 | 6 | G 1/8 | 3 | 6,0 | 46,0 | 24,9 | 14,0 | 11,5 |
| 758.018-8 M | 108681 | 8 | G 1/8 | 3 | 6,0 | 49,6 | 24,9 | 14,0 | 13,8 |
| 758.014-6 M | 108682 | 6 | G 1/4 | 4 | 8,0 | 49,0 | 29,4 | 18,0 | 11,5 |
| 758.014-8 M | 108683 | 8 | G 1/4 | 4 | 8,0 | 53,0 | 29,4 | 18,0 | 13,8 |
| 758.014-10 M | 108684 | 10 | G 1/4 | 4 | 8,0 | 62,8 | 29,4 | 18,0 | 16,5 |
| 758.014-12 M | 108685 | 12 | G 1/4 | 4 | 8,0 | 66,0 | 29,4 | 18,0 | 19,5 |
| 758.038-8 M | 108686 | 8 | G 3/8 | 5 | 9,0 | 57,0 | 35,6 | 22,0 | 13,8 |
| 758.038-10 M | 108687 | 10 | G 3/8 | 5 | 9,0 | 65,6 | 35,6 | 22,0 | 15,5 |
| 758.038-12 M | 108688 | 12 | G 3/8 | 5 | 9,0 | 69,6 | 35,6 | 22,0 | 19,5 |
| 758.012-12 M | 108689 | 12 | G 1/2 | 8 | 11,0 | 73,0 | 40,8 | 26,0 | 19,5 |

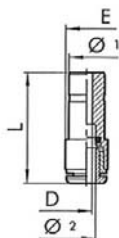

757.0604

Gerade Steckverbindungen mit Stecknippel, reduzierend

| Artikel Nr. | Ident Nr. | Ø 1 mm | Ø 2 mm | L mm | D mm | E mm |
|-------------|-----------|--------|--------|------|------|------|
| 757.0403 | 108771 | 4 | 3 | 26,0 | 2,0 | 6,3 |
| 757.0604 | 108772 | 6 | 4 | 29,9 | 2,8 | 9,5 |
| 757.0605 | 108773 | 6 | 5 | 36,0 | 4,0 | 12,0 |
| 757.0804 | 108774 | 8 | 4 | 28,7 | 2,8 | 9,5 |
| 757.0805 | 108775 | 8 | 5 | 34,5 | 4,0 | 12,0 |
| 757.0806 | 108776 | 8 | 6 | 31,9 | 4,5 | 11,5 |
| 757.1006 | 108777 | 10 | 6 | 36,2 | 5,0 | 11,5 |
| 757.1008 | 108778 | 10 | 8 | 40,8 | 7,0 | 14,0 |
| 757.1208 | 108779 | 12 | 8 | 40,1 | 7,0 | 15,5 |
| 757.1210 | 108780 | 12 | 10 | 44,3 | 8,2 | 16,0 |
| 757.1410 | 108781 | 14 | 10 | 44,3 | 8,2 | 16,0 |
| 757.1412 | 108782 | 14 | 12 | 50,0 | 10,0 | 19,5 |

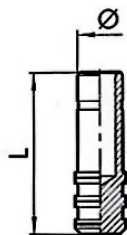

758.006

Verschlussstecker

| Artikel Nr. | Ident Nr. | Ø mm | L mm |
|-------------|-----------|------|------|
| 758.003 | 108790 | 3 | 20,0 |
| 758.004 | 108791 | 4 | 27,0 |
| 758.005 | 108792 | 5 | 27,0 |
| 758.006 | 108793 | 6 | 29,8 |
| 758.008 | 108794 | 8 | 33,6 |
| 758.010 | 108795 | 10 | 36,8 |
| 758.012 | 108796 | 12 | 39,0 |
| 758.014 | 108797 | 14 | 39,5 |

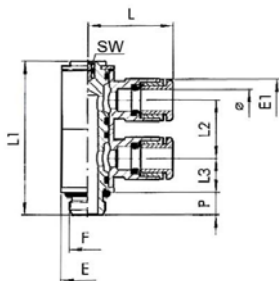

759.018-4 M

L-Mehrfachverteiler mit Innensechskant, 2-fach, drehbar, Außengewinde zylindrisch mit O-Ring

| Artikel Nr. | Ident Nr. | Ø mm | F mm | SW mm | E mm | E1 mm | L mm | L1 mm | L2 mm | L3 mm | P mm |
|--------------|-----------|------|-------|-------|------|-------|------|-------|-------|-------|------|
| 759.005-4 M | 108798 | 4 | M5 | 2 | 9,5 | 9,5 | 20,2 | 30,3 | 11,5 | 6,8 | 4,0 |
| 759.005-6 M | 108799 | 6 | M5 | 2 | 9,5 | 11,3 | 23,5 | 30,3 | 11,5 | 6,8 | 4,0 |
| 759.018-4 M | 108800 | 4 | G 1/8 | 3 | 14,0 | 9,0 | 20,2 | 40,9 | 15,5 | 9,1 | 6,0 |
| 759.018-5 M | 108801 | 5 | G 1/8 | 5 | 14,0 | 12,0 | 25,0 | 42,0 | 15,0 | 10,5 | 6,0 |
| 759.018-6 M | 108802 | 6 | G 1/8 | 3 | 14,0 | 11,3 | 23,5 | 40,9 | 15,5 | 9,1 | 6,0 |
| 759.018-8 M | 108803 | 8 | G 1/8 | 3 | 14,0 | 13,8 | 24,8 | 40,9 | 15,5 | 9,1 | 6,0 |
| 759.014-6 M | 108804 | 6 | G 1/4 | 4 | 18,0 | 11,5 | 23,0 | 47,0 | 17,2 | 10,2 | 8,0 |
| 759.014-8 M | 108805 | 8 | G 1/4 | 4 | 18,0 | 13,8 | 26,5 | 47,0 | 17,2 | 10,2 | 8,0 |
| 759.014-10 M | 108806 | 10 | G 1/4 | 4 | 18,0 | 16,5 | 31,4 | 47,0 | 17,2 | 10,2 | 8,0 |

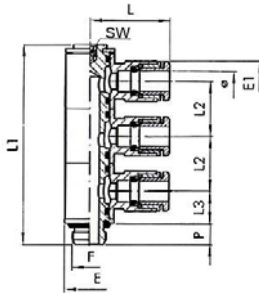

760.018-4 M

L-Mehrfachverteiler mit Innensechskant, 3-fach, drehbar, Außengewinde zylindrisch mit O-Ring

| Artikel Nr. | Ident Nr. | Ø mm | F mm | SW mm | E mm | E1 mm | L mm | L1 mm | L2 mm | L3 mm | P mm |
|--------------|-----------|------|-------|-------|------|-------|------|-------|-------|-------|------|
| 760.018-4 M | 108807 | 4 | G 1/8 | 3 | 14,0 | 9,5 | 20,2 | 56,7 | 15,5 | 9,1 | 6,0 |
| 760.018-6 M | 108808 | 6 | G 1/8 | 3 | 14,0 | 11,5 | 23,5 | 56,7 | 15,5 | 9,1 | 6,0 |
| 760.018-8 M | 108809 | 8 | G 1/8 | 3 | 14,0 | 13,8 | 24,8 | 56,7 | 15,5 | 9,1 | 6,0 |
| 760.014-6 M | 108810 | 6 | G 1/4 | 4 | 18,0 | 11,5 | 25,6 | 64,3 | 17,2 | 10,2 | 8,0 |
| 760.014-8 M | 108811 | 8 | G 1/4 | 4 | 18,0 | 13,8 | 26,5 | 64,3 | 17,2 | 10,2 | 8,0 |
| 760.014-10 M | 108812 | 10 | G 1/4 | 4 | 18,0 | 16,5 | 31,4 | 64,3 | 17,2 | 10,2 | 8,0 |

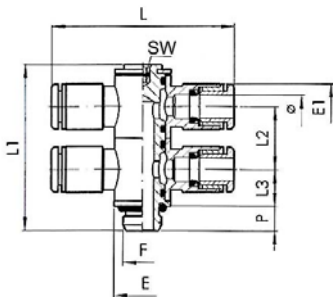

761.018-4 M

T-Mehrfachverteiler mit Innensechskant, 4-fach, drehbar, Außengewinde zylindrisch mit O-Ring

| Artikel Nr. | Ident Nr. | Ø mm | F mm | SW mm | E mm | E1 mm | L mm | L1 mm | L2 mm | L3 mm | P mm |
|--------------|-----------|------|-------|-------|------|-------|------|-------|-------|-------|------|
| 761.005-4 M | 108813 | 4 | M5 | 2 | 9,5 | 9,5 | 40,4 | 29,9 | 11,5 | 6,8 | 4,0 |
| 761.005-6 M | 108814 | 6 | M5 | 2 | 9,5 | 11,3 | 47,0 | 29,9 | 11,5 | 6,8 | 4,0 |
| 761.018-4 M | 108815 | 4 | G 1/8 | 3 | 14,0 | 9,5 | 40,4 | 40,9 | 15,5 | 9,1 | 6,0 |
| 761.018-6 M | 108816 | 6 | G 1/8 | 3 | 14,0 | 11,3 | 46,0 | 41,1 | 15,5 | 9,1 | 6,0 |
| 761.018-8 M | 108817 | 8 | G 1/8 | 3 | 14,0 | 13,8 | 49,6 | 41,1 | 15,5 | 9,1 | 6,0 |
| 761.014-6 M | 108818 | 6 | G 1/4 | 4 | 18,0 | 11,3 | 49,0 | 47,0 | 17,2 | 10,2 | 8,0 |
| 761.014-8 M | 108818 | 8 | G 1/4 | 4 | 18,0 | 13,8 | 53,0 | 47,0 | 17,2 | 10,2 | 8,0 |
| 761.014-10 M | 108819 | 10 | G 1/4 | 4 | 18,0 | 16,5 | 62,8 | 47,0 | 17,2 | 10,2 | 8,0 |

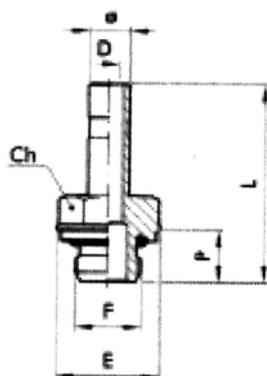

768.014-6

Gewinde-Stecknippel, Außengewinde zylindrisch mit O-Ring

Durch Kombination mit geraden Steckverbindungen, L- und T-Verbindungen können die wichtigsten Anschlussvarianten erstellt und gleichzeitig die Lagerhaltungskosten gesenkt werden.

| Artikel Nr. | Ident Nr. | Ø mm | F mm | SW mm | P mm | L mm | D mm | E mm |
|-------------|-----------|---------|---------|----------|---------|---------|---------|---------|
| 768.005-3 | 108699 | 3 | M5 | 5 | 3,5 | 17,1 | 2,0 | 5,8 |
| 768.005-4 | 108700 | 4 | M5 | 8 | 4,0 | 25,2 | 2,5 | 9,0 |
| 768.005-5 | 108701 | 5 | M5 | 8 | 4,0 | 25,2 | 2,7 | 9,0 |
| 768.005-6 | 108702 | 6 | M5 | 9 | 4,0 | 25,7 | 2,7 | 10,0 |
| 768.018-4 | 108703 | 4 | G 1/8 | 13 | 6,0 | 28,9 | 2,5 | 15,0 |
| 768.018-5 | 108704 | 5 | G 1/8 | 13 | 6,0 | 28,9 | 3,0 | 15,0 |
| 768.018-6 | 108705 | 6 | G 1/8 | 13 | 6,0 | 29,4 | 4,0 | 15,0 |
| 768.018-8 | 108706 | 8 | G 1/8 | 13 | 6,0 | 30,6 | 5,5 | 15,0 |
| 768.014-4 | 108707 | 4 | G 1/4 | 14 | 8,0 | 32,4 | 2,2 | 18,0 |
| 768.014-5 | 108708 | 5 | G 1/4 | 14 | 8,0 | 32,4 | 3,0 | 18,0 |
| 768.014-6 | 108709 | 6 | G 1/4 | 14 | 8,0 | 32,9 | 4,0 | 18,0 |
| 768.014-8 | 108710 | 8 | G 1/4 | 14 | 8,0 | 34,0 | 6,0 | 18,0 |
| 768.014-10 | 108711 | 10 | G 1/4 | 14 | 8,0 | 38,2 | 7,8 | 18,0 |
| 768.014-12 | 108712 | 12 | G 1/4 | 14 | 8,0 | 40,7 | 7,8 | 18,0 |
| 768.038-8 | 108713 | 8 | G 3/8 | 17 | 9,0 | 35,4 | 6,0 | 22,0 |
| 768.038-10 | 108714 | 10 | G 3/8 | 17 | 9,0 | 38,7 | 8,0 | 22,0 |
| 768.038-12 | 108715 | 12 | G 3/8 | 17 | 9,0 | 42,2 | 10,0 | 22,0 |
| 768.038-14 | 108716 | 14 | G 3/8 | 17 | 9,0 | 46,2 | 10,0 | 22,0 |
| 768.012-10 | 108717 | 10 | G 1/2 | 19 | 11,0 | 41,0 | 8,0 | 26,0 |
| 768.012-12 | 108718 | 12 | G 1/2 | 22 | 11,0 | 44,2 | 10,0 | 26,0 |
| 768.012-14 | 108719 | 14 | G 1/2 | 22 | 11,0 | 48,2 | 12,0 | 26,0 |

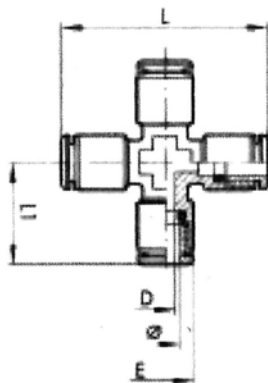

767.006

X-Steckverbindungen

| Artikel Nr. | Ident Nr. | Ø mm | D mm | E mm | L mm | L1 mm |
|-------------|-----------|------|------|------|------|-------|
| 767.004 | 108768 | 4 | 3,0 | 9,5 | 37,2 | 18,6 |
| 767.006 | 108769 | 6 | 4,5 | 11,3 | 43,8 | 21,9 |
| 767.008 | 108770 | 8 | 6,5 | 14,0 | 50,8 | 25,4 |

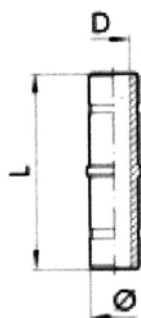

769.006

| Artikel Nr. | Ident Nr. | Ø mm | L mm | D mm |
|-------------|-----------|------|------|------|
| 769.004 | 108783 | 4 | 34,0 | 2,0 |
| 769.005 | 108784 | 5 | 34,0 | 3,0 |
| 769.006 | 108785 | 6 | 37,5 | 4,0 |
| 769.008 | 108786 | 8 | 37,5 | 6,0 |
| 769.010 | 108787 | 10 | 45,0 | 8,0 |
| 769.012 | 108788 | 12 | 48,0 | 10,0 |
| 769.014 | 108789 | 14 | 58,0 | 12,0 |

Sortimentsbox Schnellsteckverbindungen

Serie »click-clock«

Handliche, robuste und qualitativ hochwertige Kunststoff- Sortimentsbox mit den gängigsten Teilen unserer Schnellsteckverbinder aus Messing vernickelt, Serie »click-clock «

Insgesamt 30 verschiedene Sorten von Kleinteilen sind in 24 Kunststoffboxen übersichtlich präsentiert. Die Einsätze können herausgenommen und in der Box selbst individuell platziert werden. Alle Einsätze sind mit den Artikelnummern der beinhalteten Teile beschriftet.

Bestückung:

- 45 gerade Steckverschraubungen G 1/8-4 • G 1/8-6 • G 1/4-8 • G 3/8-8
- 35 L-Steckverschraubungen G 1/8-4 • G 1/8-6 • G 1/4-6 • G 1/4-8 • G 3/8-8
- 15 gerade Steckverbindungen 4, 6, 8 mm
- 10 L-Steckverbindungen 6, 8 mm
- 15 T-Verbinder 4, 6, 8 mm
- 15 drehbare T-Steckverschraubungen G 1/8-6 • G 1/4-6 • G 1/4-8
- 9 gerade Steckverbindungen mit Stecknippel, reduzierend 8/6 • 10/6 • 10/8
- 10 Verschlussstecker 6, 8 mm
- 10 Muffen G 1/8 • G 1/4 • G 3/8
- 1 PTFE-Dichtband
- 1 Schlauchabschneider

| Artikel Nr. | Ident Nr. |
|-------------|-----------|
| PIB 200 | 108821 |



PIB 200